



Micro-Scope 3a

Category

B) Test Equipment

Description

Handheld DMX512 and MIDI Tester



Mechanical

- Housing: Handheld Case
- Material: Metal
- Overall Dimensions: 45mm (H) x 125mm (W) x 98 mm (D)
- Mass: 0.53kg
- Mounting: Desktop or Rear Mounting (M4 attachment)
- Country of Manufacture: United Kingdom

Electrical

- Input Voltage: 9VDC
- Input Connector: DC Jack
- Input Power (max): 2W
- Output Voltage: Internal Battery: 25 hours
- Output Connector: Charge Time: approx 4 hours
- Duty Cycle: 80% @ 25°C

Environmental

- Operating Temperature: 0°C to 40°C
- Storage Temperature: -10°C to +50°C
- Operating Relative Humidity (max): 80% Non-Condensing
- IP Rating: IP20 Indoor Use Only
- Certification: CE FCC, WEEE
- Warranty: 2 Year (Return to Base)

User Interface / Indication

- Connections: (1) 5pin Male XLR DMX Input
- (1) 5pin Female XLR DMX Output
- (1) DC Jack DC Voltage
- User Interface: (6) Menu Select Buttons
- Configuration: Memory Programming: Manual, Mic-Edit
- Setup Configurations: Manual, Mic-Edit
- Indication: 2 Line Character Display

Control

- Control: DMX & MIDI Test Tool
- Input Protocols: MIDI, RS232 for programming
- DMX512, DMX512(1990), DMX512-A
- Input Connector: 5pin Male XLR
- Output Protocols: DMX512-A, Scope Trigger
- Output Connector: 5pin Female XLR
- Configuration: Setup Menu including;
- Backlight, Menu & SIPs Disable
- Power Save, Dark Channel
- Display Options

Isolation / Protection

- Isolation: RS232 Opto-Isolated 2kV
- DMX In/Output - Ground Referenced
- MIDI Opto-Isolated
- Protection:
- Internal Resettable Fuse - Control Electronics
- +15kV ESD DMX Driver Protection

Package Contents

- Micro-Scope 3a
- User-Guide, Carry Case
- PSU-9-1.5-DCJ
- Mic-Edit Kit (pro only)
- nanoScope (pro only)

Ordering Info

Product Code: Micro-Scope 3a
Micro-Pro

Accessories (not included):

- Mic-Edit Programming Kit
- Micro-Scope Spare Battery
- Micro-Scope Spare Case
- Micro-Scope MIDI Input Cable



Mounting Drawing

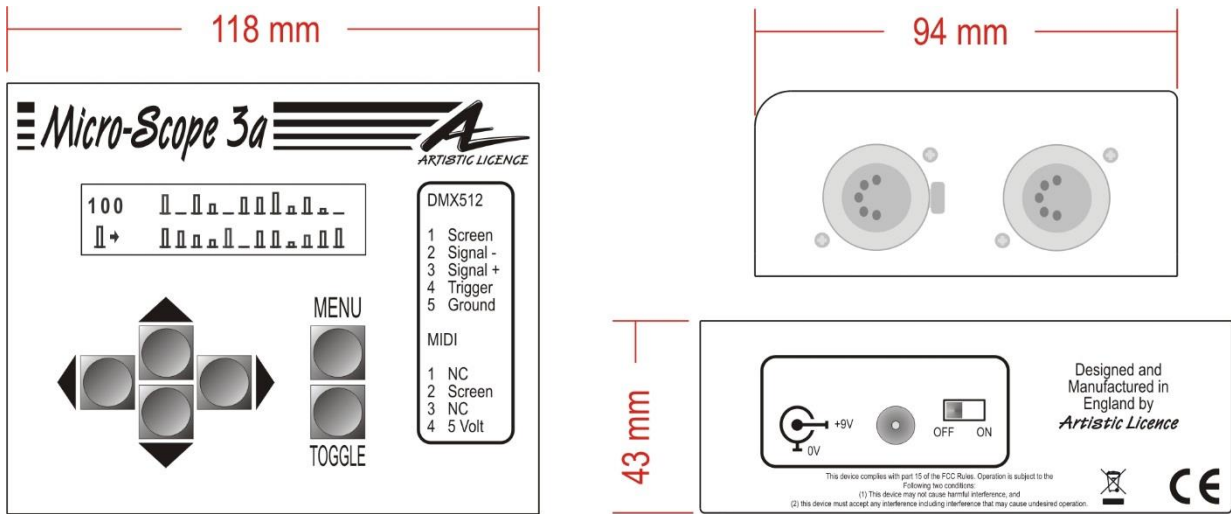

Application Drawing

Transmitting DMX - Testing fixtures

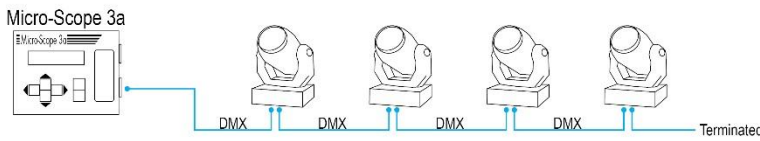

Receiving DMX - Testing DMX Controllers

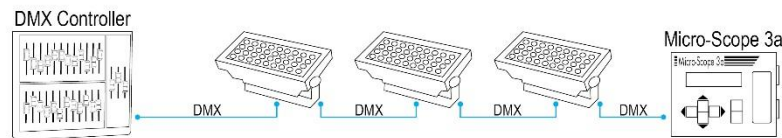

Network Test - Testing DMX Cables and Splitters

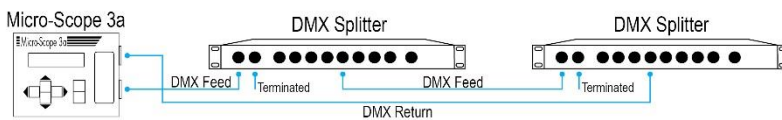

Single Ended Cable Test

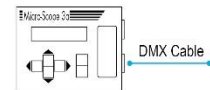

Double Ended Cable Test

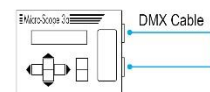

Artistic Licence Engineering Ltd

Studio 1, Spectrum House
32-34 Gordon House Road
London, NW5 1LP
United Kingdom

Telephone +44 (0)20 8863 4515
Fax +44 (0)20 8426 0551

Email: Sales@ArtisticLicence.com
www.ArtisticLicence.com

Customer support and knowledge base:
www.ArtisticLicence.com/support.html

All products are covered from date of purchase by a two-year return to base warranty.

Due to our policy of continuing product improvement, specifications are subject to change without notice.

